

FRANCIS ROAD TRAFFIC IMPROVEMENTS PROPOSALS

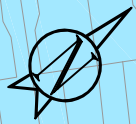
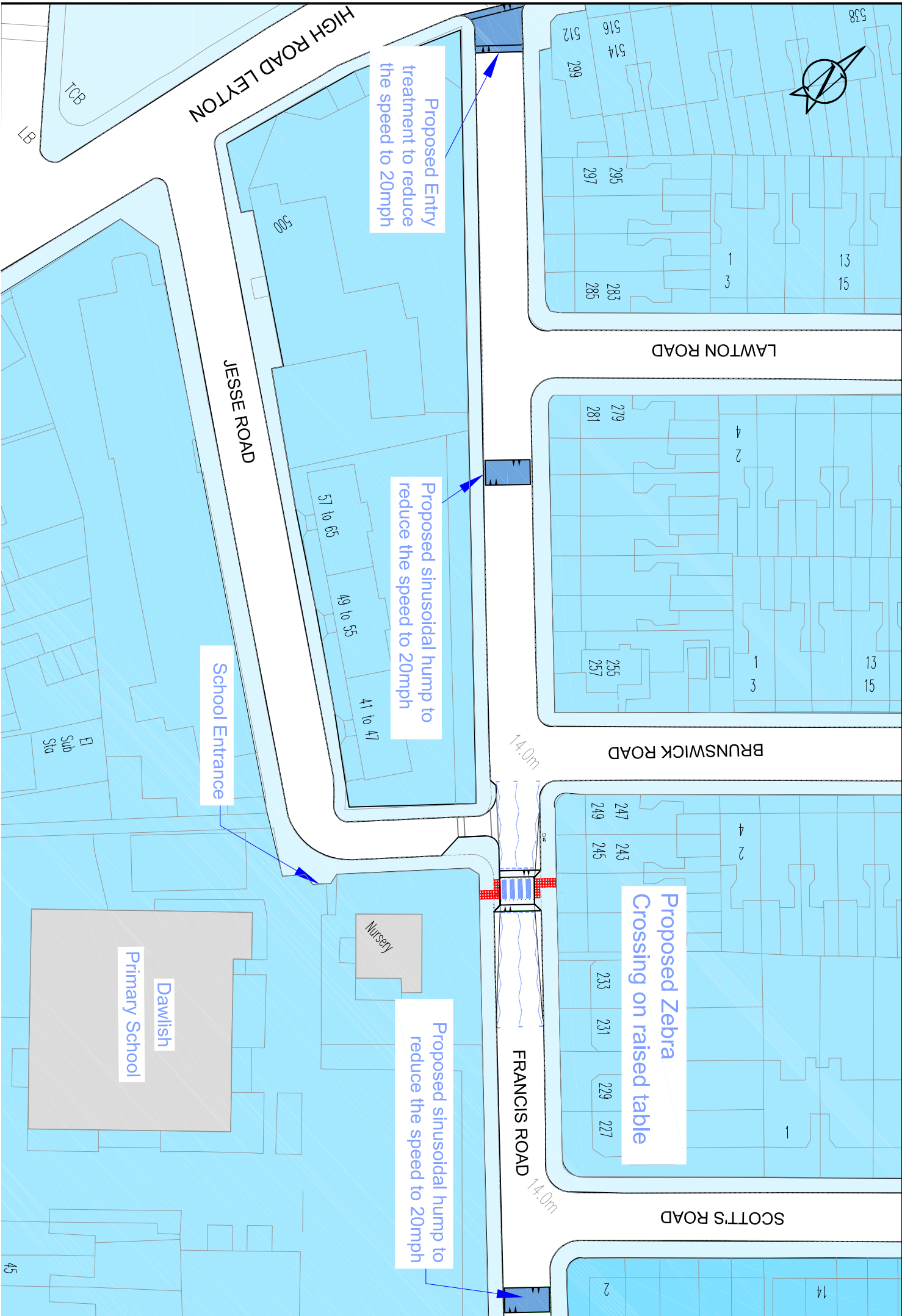

Proposed Entry treatment to reduce the speed to 20mph

Proposed sinusoidal hump to reduce the speed to 20mph

Proposed Zebra Crossing on raised table

Proposed sinusoidal hump to reduce the speed to 20mph

School Entrance

Dawlish Primary School

Nursery

FRANCIS ROAD

HIGH ROAD LEYTON

JESSE ROAD

LAWTON ROAD

BRUNSWICK ROAD

SCOTT'S ROAD

14.0m

14.0m

538
516
514
299
295
297
1
3
283
285
13
15

279
281
4
2
1
3
255
257
13
15

247
249
243
245
4
2
233
231
229
227
1

14
2

TCB
EB
500
57 to 65
49 to 55
41 to 47
El
Sub
Sto

45